

For more detailed installation instructions visit [www.LucettaLighting.com](http://www.LucettaLighting.com).

<b>Max. Amp</b>	12V - 5A / 24V - 4A	<b>Wire Gauge</b>	14 AWG - 20 AWG*
-----------------	---------------------	-------------------	------------------

\*Stranded, not tinned wire only. If utilizing 14AWG solid tinned wire, replace stock screws with included alternates.

#### 1. Cut Tape Light and Loosen Terminal

#### 2. Insert Tape Light

#### 3. Fasten Terminal

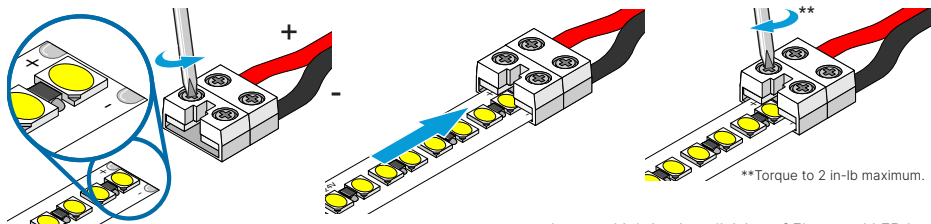

Lucetta Lighting is a division of Elemental LED Inc.

885 Trademark Drive, Suite 200 | Reno, NV 89521 | (833) 533-7732 | [info@LucettaLighting.com](mailto:info@LucettaLighting.com)

© 2022 Elemental LED Inc. All rights reserved. Specifications are subject to change without notice.