

### STREAMLITE™ Wet Location 12V and 24V Diffused Linear Light

Dot-free linear lighting without any visible LEDs. Ideal for tight spaces and simple, impactful installations. Suitable for wet locations (IP65).

Date \_\_\_\_\_

Project Notes \_\_\_\_\_



#### FEATURES

- Uniform, diffused light appears dotless even without a diffusing lens
- Very small size, ideal for tight spaces
- 180° beam angle for even light distribution
- Compatible with channels and other popular accessories
- Suitable for wet locations (IP65)
- Includes (1) open and (1) closed end cap



#### ORDERING CODES

Order spools, and components for field assembly

#### OPTIONAL ORDERING CODES

Add Assembly Preferences, Finish, Lens, Mounting, Driver, and Delivery

	Voltage	Model	CCT	Length	Channels	Finish	Lens	Mounting	Driver	Delivery		
DI												
	12V (12V Volt)	STMLT	27 (2700K)	W016 (16.4 feet)	S2 (S2)	16 (16mm Square)	45 (45°)	AL (Aluminum)	*blank* (Classic Frosted Lens)	3M (3M Adhesive)	ELV (Electronic)	Field Assembly
	24V (24V Volt)	STMLT4	30 (3000K)		S45 (S45)	RC20 (20mm Round)	M11 (1-inch Mud-In)	BL (Black)	BL (Black Lens)	MC (Mounting Clip)	O10 (0-10V)	Factory + Field (Hybrid)
			35 (3500K)		SL (Slim)	SQ20 (20mm Square)	M12 (2-inch Mud-In)	WH (White)	CLT (Arch. Clear Lens)	UC (U-Clip)	O/O (On / Off)	Factory Assembly
			40 (4000K)		CA (Canal)	SQ (Square)			FRT (Arch. Frosted Lens)	VC (Vertical Clip)	PoE (Power over Ethernet)	
									OPT (Opal Lens)	HNG (Hanging Hardware)		
									PD (Prem. Diffusion Lens)	RC (Rotating Clip)		
*See page 2 for Channel / Lens / Mounting compatibility												

#### STREAMLITE™ Wet Location - SPECIFICATION TABLE

Models	12V-STMLT	24V-STMLT	24V-STMLT4
<b>Voltage</b>	<b>12VDC</b>	<b>24VDC</b>	<b>24VDC</b>
<b>Wattage</b>	<b>3.3W/ft.</b>	<b>3.3W/ft.</b>	<b>5W/ft.</b>
Lumens	2700K - 3000K 251 Lm/ft.	221 Lm/ft. 256 Lm/ft.	376 Lm/ft. 378 Lm/ft.
	3500K - 4000K -	275 Lm/ft. 271 Lm/ft.	400 Lm/ft. 440 Lm/ft.
Cut Points	1.4 in.	1.8 in.	1.8 in.
Max Run (ft.)	16.4 ft.	20 ft.	16.4 ft.
CRI	90+	90+	90+
Dimensions	0.4 x 0.16 in. (L x W x H)	0.4 x 0.16 in. (L x W x H)	0.4 x 0.16 in. (L x W x H)
TM-21 (LM-80)	>50,000 hours	>50,000 hours	>50,000 hours
Environment	Outdoor / Wet Location (IP65)	Outdoor / Wet Location (IP65)	Outdoor / Wet Location (IP65)
Lead Wire A	36 in. Bare Lead 20/2 AWG UL 2464 Wire with Strain Relief	36 in. Bare Lead 20/2 AWG UL 2464 Wire with Strain Relief	36 in. Bare Lead 20/2 AWG UL 2464 Wire with Strain Relief
Lead Wire B	36 in. Bare Lead 20/2 AWG UL 2464 Wire with Strain Relief	36 in. Bare Lead 20/2 AWG UL 2464 Wire with Strain Relief	36 in. Bare Lead 20/2 AWG UL 2464 Wire with Strain Relief
LED Chips	176/ft.	176/ft.	176/ft.
Certification	UL Listed 2108	UL Listed 2108	UL Listed 2108
Warranty	5 Year	7 Year	7 Year

### STREAMLITE™ Wet Location 12V and 24V Diffused Linear Light

Dot-free linear lighting without any visible LEDs. Ideal for tight spaces and simple, impactful installations. Suitable for wet locations (IP65).

Date \_\_\_\_\_

Project Notes \_\_\_\_\_



### CHANNEL / LENS / MOUNTING COMPATIBILITY

Channel	Compatible Lenses	Available Finishes	Mounting Options
S2 (S2)	*blank*	AL	UC
S45 (S45)	*blank*	AL	UC
SL (Slim)	*blank* / CLT / FRT / BL / PD	AL / WH / BL	MC / 3M / MAG
CA (Canal)	OPT	AL / WH / BL	UC
16 (16mm Square)	FRT	AL	MC
RC20 (20mm Round)	*blank*	AL	UC
SQ20 (20mm Square)	*blank*	AL	UC
SQ (Square)	*blank* / CLT / FRT / BL / PD	AL / WH / BL	MC / VC / RC / HNG
45 (45°)	*blank* / CLT / FRT / BL / PD	AL / WH / BL	MC / VC / RC / HNG
M11 (1-inch Mud-In)	OPT	AL	
M12 (2-inch Mud-In)	OPT	AL	

### LEGEND

Lens		Finish		Mounting	
*blank*	Classic Frosted Lens	AL	Aluminum	3M	3M Adhesive
BL	Black Lens	WH	White	HNG	Hanging Hardware
CLT	Architectural Clear Lens	BL	Black	MAG	Magnetic Clip
FRT	Architectural Frosted Lens			MC	Mounting Clip
OPT	Opal Lens			RC	Rotating Clip
PD	Premium Diffusion Lens			UC	U-Clip
				VC	Vertical Clip

### STREAMLITE™ Wet Location 12V and 24V Diffused Linear Light

Dot-free linear lighting without any visible LEDs. Ideal for tight spaces and simple, impactful installations. Suitable for wet locations (IP65).

Date \_\_\_\_\_

Project Notes \_\_\_\_\_



### RECOMMENDED CHANNELS

MODEL	DIAGRAM	INCLUDED ACCESSORIES	CONNECTION OPTIONS	IN CHANNEL DIFFUSION	TECHNICAL RATINGS	MOUNTING OPTIONS WITH DIMENSIONS
<b>S2 Channel</b> DI-CHB-S2  (S2) 48", 96" Aluminum For 14mm Tape Lights or smaller		48 in. Channel & Frosted Lens, 1 open end cap, 1 closed end cap, 2 mounting clips, 2 mounting screws  96 in. Channel & Frosted Lens, 2 open end cap, 2 closed end cap, 4 mounting clips, 4 mounting screws		Classic Frosted Lens STMLT, STMLT4: Dotless	<ul style="list-style-type: none"> <li>Beam Angle: 120°</li> <li>Classic Frosted Lens</li> <li>Light Loss: 20%</li> <li>CCT Shift: -40K</li> <li>IP Rating Shift: IP40</li> </ul>	<p>U-Clip: 0.58 × 0.75 in. (H x W)</p>
<b>S45 Channel</b> DI-CHB-S45  (S45) 48", 96" Aluminum For 14mm Tape Lights or smaller		48 in. Channel & Frosted Lens, 1 open end cap, 1 closed end cap, 2 mounting clips, 2 mounting screws  96 in. Channel & Frosted Lens, 2 open end cap, 2 closed end cap, 4 mounting clips, 4 mounting screws		Classic Frosted Lens STMLT, STMLT4: Dotless	<ul style="list-style-type: none"> <li>Beam Angle: 120°</li> <li>Classic Frosted Lens</li> <li>Light Loss: 20%</li> <li>CCT Shift: -40K</li> <li>IP Rating Shift: IP40</li> </ul>	<p>U-Clip: 0.79 × 0.79 in. (H x W)</p>
<b>Slim Channel</b> DI-CPCHB-SL  (SL) 48", 96" Aluminum, White, Black For 14mm Tape Lights or smaller		48" Aluminum, Black, & White Channels • 48 in. channel & lens • 2x surface mounting clips • End caps: 1x open, 1x closed  96" Aluminum, Black, & White Channels • 96 in. channel & lens • 4x surface mounting clips • end caps: 2x open, 2x closed		Architectural Frosted Lens STMLT, STMLT4: Dotless  Premium Diffusion Lens STMLT, STMLT4: Dotless  For diffusion options not listed, refer to Slim Channel Specification Sheet.	<ul style="list-style-type: none"> <li>Beam Angle: 120°</li> <li>Architectural Clear Lens</li> <li>Light Loss: 10%</li> <li>CCT Shift: -20K</li> <li>Architectural Frosted Lens</li> <li>Light Loss: 30%</li> <li>CCT Shift: -35K</li> <li>Classic Frosted Lens</li> <li>Light Loss: 20%</li> <li>CCT Shift: -40K</li> <li>Black Lens</li> <li>Light Loss: 90%</li> <li>CCT Shift: -350K</li> <li>Premium Diffusion Lens</li> <li>Light Loss: 10%</li> <li>CCT Shift: -30K</li> <li>IP Rating Shift: IP40</li> </ul>	<p>Slim Mount: 0.54 × 0.87 in. (H x W)            3M Adhesive: 0.48 × 0.82 in. (H x W)            Magnetic U-Clip: 0.59 × 0.82 in. (H x W)            Premium Diffusion: 0.96 × 0.82 in. (H x W)</p>
<b>Canal Channel</b> DI-CPCHB-CAN  (CA) 48", 96" Aluminum, White, Black For 14mm Tape Lights or smaller		48" Aluminum, Black, & White Channels • 48 in. channel & opal lens • 2x surface mounting clips • End caps: 1x open, 1x closed.  96" Aluminum, Black, & White Channels • 96 in. channel & opal lens • 4x surface mounting clips • End caps: 2x open, 2x closed.		Opal Lens STMLT, STMLT4: Dotless	<ul style="list-style-type: none"> <li>Beam Angle: 120°</li> <li>Opal Lens</li> <li>Light Loss: 55%</li> <li>CCT Shift: -200K</li> <li>IP Rating Shift: IP40</li> </ul>	<p>U-Clip: 0.6 × 0.7 in. (H x W)</p>

### STREAMLITE™ Wet Location 12V and 24V Diffused Linear Light

Dot-free linear lighting without any visible LEDs. Ideal for tight spaces and simple, impactful installations. Suitable for wet locations (IP65).

Date \_\_\_\_\_

Project Notes \_\_\_\_\_



### RECOMMENDED CHANNELS

MODEL	DIAGRAM	INCLUDED ACCESSORIES	CONNECTION OPTIONS	IN CHANNEL DIFFUSION	TECHNICAL RATINGS	MOUNTING OPTIONS WITH DIMENSIONS
<b>16mm Square Channel</b> DI-CPCHB-16MM  (16) 48", 96" Aluminum For 14mm Tape Lights or smaller	Height (H): 0.89 in. Width (W): 0.77 in. Interior Width (IW): 0.63 in.  	48 in. channel & Architectural Frosted Lens 2x surface mounting clips End caps: 1x open, 1x closed.  96 in. channel & Architectural Frosted Lens 4x surface mounting clips End caps: 2x open, 2x closed.	 12mm Tape Light: Soldered Lead Only	Architectural Frosted Lens STMLT, STMLT4: Dotless	<ul style="list-style-type: none"> <li>Beam Angle: 120°</li> <li>Architectural Frosted Lens               <ul style="list-style-type: none"> <li>Light Loss: 30%</li> <li>CCT Shift: -35K</li> </ul> </li> <li>Black Lens               <ul style="list-style-type: none"> <li>Light Loss: 90%</li> <li>CCT Shift: -350K</li> </ul> </li> <li>IP Rating Shift: IP40</li> </ul>	 Mounting Clip: 0.89 x 0.77 in. (H x W)
<b>20mm Round Channel</b> DI-CPCHB-RC20  (RC20) 48", 96" Aluminum For 14mm Tape Lights or smaller	Height (H): 1.18 in. Width (W): 1.18 in. Interior Width (IW): 0.84 in.  	48 in. channel & frosted lens 2x surface mounting clips End caps: 1x open, 1x closed.  96 in. channel & frosted lens 4x surface mounting clips End caps: 2x open, 2x closed.	 12mm Tape Light: Soldered Lead Only	Classic Frosted Lens STMLT, STMLT4: Dotless	<ul style="list-style-type: none"> <li>Beam Angle: 180°</li> <li>Classic Frosted Lens               <ul style="list-style-type: none"> <li>Light Loss: 20%</li> <li>CCT Shift: -40K</li> </ul> </li> <li>IP Rating Shift: IP40</li> </ul>	 U-Clip: 1.19 x 1.19 in. (H x W)
<b>20mm Square Channel</b> DI-CPCHB-SQC20  (SQ20) 48", 96" Aluminum For 14mm Tape Lights or smaller	Height (H): 1.18 in. Width (W): 1.18 in. Interior Width (IW): 0.84 in.  	48 in. channel & frosted lens 2x surface mounting clips End caps: 1x open, 1x closed.  96 in. channel & frosted lens 4x surface mounting clips End caps: 2x open, 2x closed.	 12mm Tape Light: Soldered Lead Only	Classic Frosted Lens STMLT, STMLT4: Dotless	<ul style="list-style-type: none"> <li>Beam Angle: 180°</li> <li>Classic Frosted Lens               <ul style="list-style-type: none"> <li>Light Loss: 20%</li> <li>CCT Shift: -40K</li> </ul> </li> <li>IP Rating Shift: IP40</li> </ul>	 U-Clip: 1.19 x 1.19 in. (H x W)
<b>Square Channel</b> DI-CPCHB-SQ  (SQ) 48", 96" Aluminum, White, Black For 14mm Tape Lights or smaller	Height (H): 0.55 in. Width (W): 0.82 in. Interior Depth (ID): 0.27 in. Interior Width (IW): 0.67 in.  	48" Aluminum Channel • 48 in. channel & frosted cover • Mounting hardware • End caps: 1x open, 1x closed.  48" Black & White Channels • 48 in. channel & clear, or frosted lens • 4x surface mounted clips • 2x End-to-end Interconnects  96" Aluminum Channel • 96 in. channel & frostedcover • Mounting hardware • End caps: 2x open, 2x closed.  96" Black & White Channels • 96 in. channel & clear, or frosted lens • 4x surface mounted clips • 2x End-to-end Interconnects	 12mm Tape Light: Soldered Lead Only	Architectural Frosted Lens STMLT, STMLT4: Dotless  Premium Diffusion Lens STMLT, STMLT4: Dotless  For diffusion options not listed, refer to Square Channel Specification Sheet.	<ul style="list-style-type: none"> <li>Beam Angle: 120°</li> <li>Architectural Clear Lens               <ul style="list-style-type: none"> <li>Light Loss: 10%</li> <li>CCT Shift: -20K</li> </ul> </li> <li>Architectural Frosted Lens               <ul style="list-style-type: none"> <li>Light Loss: 30%</li> <li>CCT Shift: -35K</li> </ul> </li> <li>Classic Frosted Lens               <ul style="list-style-type: none"> <li>Light Loss: 20%</li> <li>CCT Shift: -40K</li> </ul> </li> <li>Black Lens               <ul style="list-style-type: none"> <li>Light Loss: 90%</li> <li>CCT Shift: -350K</li> </ul> </li> <li>Premium Diffusion Lens               <ul style="list-style-type: none"> <li>Light Loss: 10%</li> <li>CCT Shift: -30K</li> </ul> </li> <li>IP Rating Shift: IP40</li> </ul>	 Chromapath Surface Mount: 0.61 x 0.82 in. (H x W)   Vertical Mount: 0.61 x 0.82 in. (H x W)   Rotating Mount: 1.29 x 0.82 in. (H x W)   Hanging Mount: 1.51 x 0.82 in. (H x W)   Premium Diffusion: 1.13 x 0.82 in. (H x W)

### STREAMLITE™ Wet Location 12V and 24V Diffused Linear Light

Dot-free linear lighting without any visible LEDs. Ideal for tight spaces and simple, impactful installations. Suitable for wet locations (IP65).

Date \_\_\_\_\_

Project Notes \_\_\_\_\_



### RECOMMENDED CHANNELS

MODEL	DIAGRAM	INCLUDED ACCESSORIES	CONNECTION OPTIONS	IN CHANNEL DIFFUSION	TECHNICAL RATINGS	MOUNTING OPTIONS WITH DIMENSIONS
<b>45° Channel</b> DI-CPCHB-45 (45) 48", 96" Aluminum, White, Black For 14mm Tape Lights or smaller		48" Aluminum, Black, & White Channels • 48 in. channel & clear, or frosted lens • 4x surface mounted clips • 2x End-to-end interconnects  96" Aluminum Channel • 96 in. channel & clear, or frosted lens • 8x surface mounted clips • 4x End-to-end interconnects  96" Black & White Channels • 96 in. channel & clear, or frosted lens • 4x surface mounted clips • 2x End-to-end interconnects	<p>12mm Tape Light: Soldered Lead Only</p>	Architectural Frosted Lens STMLT, STMLT4: Dotless  Premium Diffusion Lens STMLT, STMLT4: Dotless  For diffusion options not listed, refer to 45° Channel Specification Sheet.	<ul style="list-style-type: none"> <li>Beam Angle: 120°</li> <li>Architectural Clear Lens               <ul style="list-style-type: none"> <li>Light Loss: 10%</li> <li>CCT Shift: -20K</li> </ul> </li> <li>Architectural Frosted Lens               <ul style="list-style-type: none"> <li>Light Loss: 30%</li> <li>CCT Shift: -35K</li> </ul> </li> <li>Classic Frosted Lens               <ul style="list-style-type: none"> <li>Light Loss: 20%</li> <li>CCT Shift: -40K</li> </ul> </li> <li>Black Lens               <ul style="list-style-type: none"> <li>Light Loss: 90%</li> <li>CCT Shift: -350K</li> </ul> </li> <li>Premium Diffusion Lens               <ul style="list-style-type: none"> <li>Light Loss: 10%</li> <li>CCT Shift: -30K</li> </ul> </li> <li>IP Rating Shift: IP40</li> </ul>	<p>Chromapath Surface Mount: 1 × 0.67 in. (H x W)</p> <p>Vertical Mount: 1 × 0.67 in. (H x W)</p> <p>Rotating Mount: 1.68 × 0.67 in. (H x W)</p> <p>Hanging Mount: 1.9 × 0.67 in. (H x W)</p> <p>Premium Diffusion: 1.52 × 0.67 in. (H x W)</p>
<b>1-inch Mud-In Channel</b> DI-CPCHB-MUD1 (M1) 48", 96" Aluminum For 14mm Tape Lights or smaller		96 in. channel & opal lens 2x surface mounting clips End caps: 2x open, 2x closed.	<p>12mm Tape Light: Soldered Lead Only</p>	Opal Lens STMLT, STMLT4: Dotless	<ul style="list-style-type: none"> <li>Beam Angle: 120°</li> <li>Opal Lens               <ul style="list-style-type: none"> <li>Light Loss: 55%</li> <li>CCT Shift: -200K</li> </ul> </li> <li>IP Rating Shift: IP40</li> </ul>	<p>Recessed Mount: 0.54 × 2.42 in. (H x W)</p>
<b>2-inch Mud-In Channel</b> DI-CPCHB-MUD2 (M2) 48", 96" Aluminum For 14mm Tape Lights or smaller		96 in. channel & opal lens 2x surface mounting clips End caps: 2x open, 2x closed.	<p>12mm Tape Light: Soldered Lead Only</p>	Opal Lens STMLT, STMLT4: Dotless	<ul style="list-style-type: none"> <li>Beam Angle: 120°</li> <li>Opal Lens               <ul style="list-style-type: none"> <li>Light Loss: 55%</li> <li>CCT Shift: -200K</li> </ul> </li> <li>IP Rating Shift: IP40</li> </ul>	<p>Recessed Mount: 0.8 × 3.86 in. (H x W)</p>

### STREAMLITE™ Wet Location 12V and 24V Diffused Linear Light

Dot-free linear lighting without any visible LEDs. Ideal for tight spaces and simple, impactful installations. Suitable for wet locations (IP65).

Date \_\_\_\_\_

Project Notes \_\_\_\_\_



### RECOMMENDED 24V DRIVERS

SKU	INPUT VOLTAGE / FREQUENCY	OUTPUT VOLTAGE	MAXIMUM LOAD	MINIMUM LOAD	CLASS 2	DIMMABLE	LENGTH	WIDTH	HEIGHT
<b>OMNIDRIVE® X Dimmable Driver</b> Versatile driver for most high-performance dimming on ELV, TRIAC, and 0-10V systems. <a href="https://www.diodeled.com/custom/download/productFile/filename/omnidrive-x-specification-sheet.pdf">https://www.diodeled.com/custom/download/productFile/filename/omnidrive-x-specification-sheet.pdf</a>									
<small>OMNIDRIVE® X Dimmable Driver Specification Sheet</small> Contains: • Additional Models • Derating Curves • Additional Features • System Diagrams									
DI-ODX-24V30W-J	120-277V	24V	30W	No Minimum Load	Yes	Yes	6.5 in.	3.7 in.	1.57 in.
DI-ODX-24V60W-J	120-277V	24V	60W	No Minimum Load	Yes	Yes	7.4 in.	3.7 in.	1.57 in.
DI-ODX-24V96W-J	120-277V	24V	96W	No Minimum Load	Yes	Yes	8.66 in.	3.7 in.	1.57 in.
DI-ODX-24V120W-J	120-277V	24V	120W	No Minimum Load	No	Yes	8.66 in.	3.7 in.	1.57 in.
<b>OMNIDRIVE® Electronic Dimmable Driver</b> Our classic electronic dimmable (ELV) driver. Superior dimming and wide compatibility with popular dimmers. <a href="https://www.diodeled.com/custom/download/productFile/filename/omnidrive-indoor-electronic-dimmable-driver-specification-sheet.pdf">https://www.diodeled.com/custom/download/productFile/filename/omnidrive-indoor-electronic-dimmable-driver-specification-sheet.pdf</a>									
<small>OMNIDRIVE® Electronic Dimmable Driver Specification Sheet</small> Contains: • Additional Models • Derating Curves • Additional Features • System Diagrams									
DI-TD-24V-45W-LPS3R	90-135VAC at ~50/60Hz	24V	45W	Load at least 60% labeled load	Yes	Yes	10.79 in.	7.34 in.	2.36 in.
DI-TD-24V-60W-LPS3R	90 ~ 135VAC 50/60Hz	24V	60W	Load at least 60% labeled load	Yes	Yes. Not compatible with PWM controls.	10.79 in.	7.34 in.	2.36 in.
DI-TD-24V-80W-LPS3R	90 ~ 135VAC 50/60Hz	24V	80W	Load at least 60% labeled load	Yes	Yes. Not compatible with PWM controls.	10.79 in.	7.34 in.	2.36 in.
<b>VLM Series Constant Voltage Driver</b> Compact driver for on/off, PWM dimming, and color-changing applications. <a href="https://www.diodeled.com/custom/download/productFile/filename/VLM-Specification%20Sheet%20(Driver%20&amp;%20J-Box).pdf">https://www.diodeled.com/custom/download/productFile/filename/VLM-Specification%20Sheet%20(Driver%20&amp;%20J-Box).pdf</a>									
<small>VLM Series Constant Voltage Driver Specification Sheet</small> Contains: • Additional Models • Derating Curves • Additional Features • System Diagrams									
VLM60W-24-LPS3R	120 / 277VAC 47 - 63Hz	24V	60W	No Minimum Load	Yes	PWM	10.79 in.	7.34 in.	2.36 in.
VLM60W-24-LPM	120 / 277VAC 47 - 63Hz	24V	60W	No Minimum Load	Yes	PWM	8.19 in.	2.94 in.	1.31 in.
<b>PoE (Power over Ethernet)</b> Constant voltage platform, ready for Power over Ethernet (inquire)									

### RECOMMENDED CONTROLLERS

SKU	DESCRIPTION
<b>CASAMBI® Controllers</b> The CASAMBI controllers will remotely control your lighting through the app - downloadable for IOS & Android.	
CBU-PWM4	CASAMBI PWM4 Single Color Dimming Controller
CBU-A2D	CASAMBI A2D 2 Channel 0-10V/DALI Controller
CBU-ASR	CASAMBI ASR 0-10V Controller
CBU-TED	CASAMBI TED AC High Voltage Controller
<b>SWITCHEX® Driver and Dimmer Switch</b> LED driver and dimmer switch combined in a single gang box.	
DI-24V-SE-60W	SWITCHEX 24V Switch/Driver Combo - 60W
DI-24V-SE-100W	SWITCHEX 24V Switch/Driver Combo - 100W



**STREAMLITE™ Wet Location 12V and 24V**  
**Diffused Linear Light**

Dot-free linear lighting without any visible LEDs. Ideal for tight spaces and simple, impactful installations. Suitable for wet locations (IP65).

Date \_\_\_\_\_

Project Notes \_\_\_\_\_



**MECHANICAL DIAGRAMS**

**12V-STMLT**

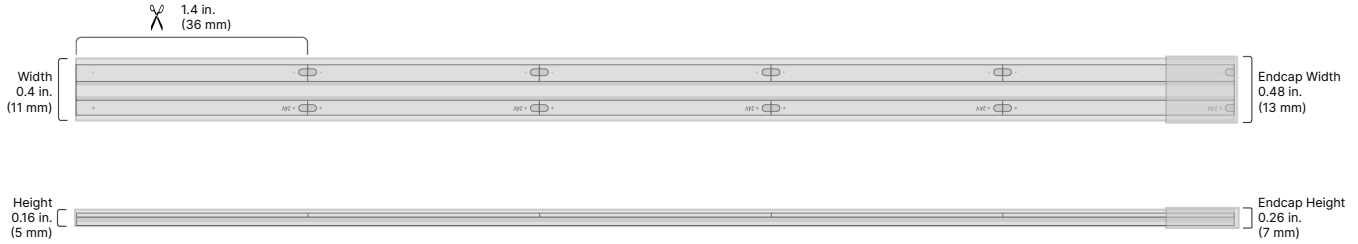

**24V-STMLT**  
**24V-STMLT4**

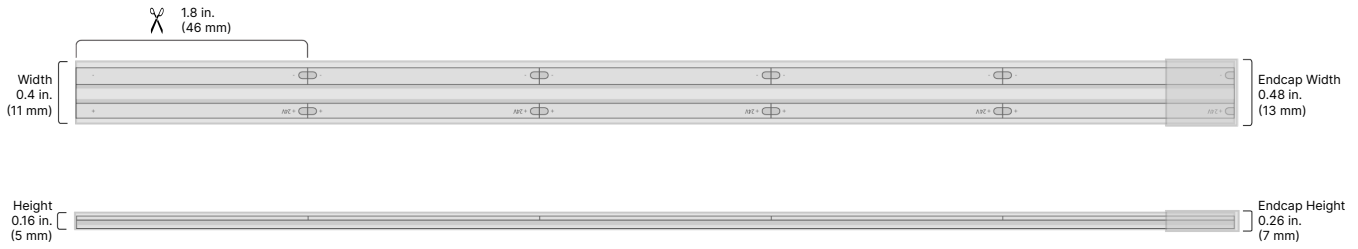

**CONNECTIONS**

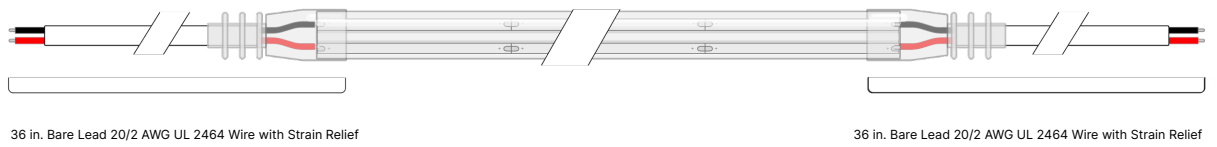

### STREAMLITE™ Wet Location 12V and 24V Diffused Linear Light

Dot-free linear lighting without any visible LEDs. Ideal for tight spaces and simple, impactful installations. Suitable for wet locations (IP65).

Date \_\_\_\_\_

Project Notes \_\_\_\_\_



#### ACCESSORIES

##### Soldered Lead Only

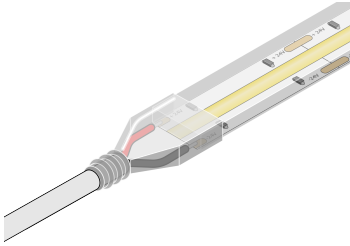

##### DI-WL-EC

BLAZE Wet Location Strip Light End Cap Set, 5-pack, 5 open and 5 closed

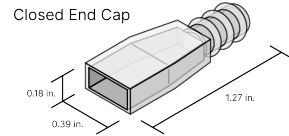
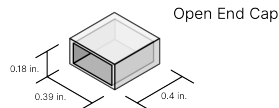

##### DI-0754

Wet Location Strip Light Mounting Clips - Set of 10

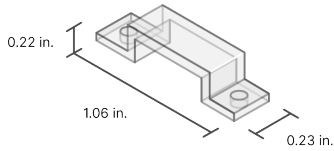

##### DI-WPSL

Wet Location Sealant

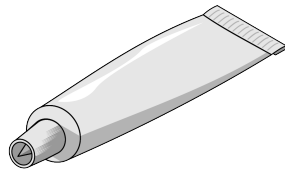

#### DELIVERY OPTIONS

- Field Assembly**  
 Fastest order fulfillment. Field connectors and accessories not included.
- Factory + Field (Hybrid)**  
 Onsite modifications with factory connection. Additional accessories not included.
- Factory Assembly**  
 Fastest Installation. Factory made-to-order fixtures.

- Lumen value measured in accordance to IES LM-80-08. LED chips have a luminous flux range with a tolerance of +/- 5%.
- Each maximum run requires a dedicated power feed from the driver. Do not extend beyond the recommended maximum run length. Max run may exceed Class 2 limit. Actual wattage may differ from calculated wattage due to voltage drop across run.
- Do not install product in an environment outside the listed ambient temperature. Exceeding the maximum ambient temperature may damage LED chips, reduce the total lamp life, lumen output, and/or adversely impact color consistency.
- Actual efficacy value is dependent to specified LED driver (power supply). An estimated efficacy value can be calculated as follows: Lumen value divided by average power consumption per foot.
- Operating temperature is measured according to the minimum and maximum ambient temperature environment.



### STREAMLITE™ Wet Location 12V and 24V

#### Diffused Linear Light

Dot-free linear lighting without any visible LEDs. Ideal for tight spaces and simple, impactful installations. Suitable for wet locations (IP65).

Date \_\_\_\_\_

Project Notes \_\_\_\_\_



## CERTIFICATIONS

### Safety

- UL Listed 2108 Flexible Lighting Systems. Certified for United States and Canada. File # E469769.
- UL Listed Field Cuttable.
- Approved for storage areas of clothes closets per NEC 410.16.A.1 and 410.16.C.1,3

### Environment

- Ambient Temperature: -4 ~ 122°F (-20 ~ 50°C)
- Operating Temperature: -4 ~ 176°F (-20 ~ 80°C)
- RoHS Compliant: Verification No. CANEC1610091501

### Performance

- Can be used to comply with TITLE 24 Part 6 High Efficacy Lighting LED requirements - JA8-2016-2022-E
- Photometric & Colorimetry data measured in accordance to IES LM-79-08, in Elemental LED's Innovation Lab.

### Safety / Warnings / Disclosures

1. Install in accordance with national and local electrical code regulations.
2. This product is intended to be installed and serviced by a qualified, licensed electrician.
3. Only use copper wiring. Use wires rated for at least 176°F (80°C) and certified for use with external connection of electrical equipment.
4. Each maximum run requires a dedicated power feed from the driver. Do not extend beyond the recommended maximum run length.
5. Tape light, attached wire leads, and additional extension cables, connectors, etc., are not rated for in-wall installation unless otherwise noted. Tape light and attached wire leads are field-cuttable.
6. Maximum Run values are calculated to show the total length a product may be connected in series without experiencing significant voltage drop and light loss. A product's listed Maximum Run may be greater than its longest purchasable length.
7. Ensure applicable wire is installed between driver, fixture, and any controls in-between. When choosing wire, factor in voltage drop, amperage rating, and type (in-wall rated, wet location rated, etc.). Inadequate wire installation could overheat wires, and cause fire.
8. Do not install in environment where LED chips are exposed to direct sunlight as damage to the phosphor will occur.
9. Do not install in environment where excessive heat may exist (ex. close proximity to fireplace, etc.) See Ambient Temperature ratings
10. Do not install indoor LED tape light products in outdoor / wet location environments. Only wet location tape light models are rated for outdoor / wet locations.
11. Do not modify product beyond instructions or warranty will be void.
12. Tape light must be handled with care. Excessive handling, bending, and pressure may damage the product, voiding the warranty.
13. Actual color may vary from what is pictured on this sheet and other print materials due to the limitations of photographic processes.

## WARRANTY

### Limited Warranty

- 5 Year and 7 Year limited warranties

This warranty does not include the additional accessories referenced in this specification sheet. Complete warranty details for fixtures and additional accessories are available at [www.diodeled.com/limited-warranty/](http://www.diodeled.com/limited-warranty/) within the Policies section. For warranty related questions please contact product support.

### Consumer's Acknowledgment

Elemental LED, Inc. stands behind its products when they are used properly and according to our specifications. By purchasing our products, the purchaser agrees and acknowledges that lighting design, configuration and installation is a complex process, wherein seemingly minor factors or changes in layout and infield adjustments can have a significant impact on an entire system. Choosing the correct components is essential. Elemental LED is able to work with the original purchaser to make an appropriate product selection to the extent of the limited information that the customer can provide, but it is virtually impossible for Elemental LED to design a system that foresees every unknown factor. For this reason, this Warranty does not cover problems caused by improper design, configuration or installation issues. Any statement from a Elemental LED employee or agent regarding a customer's bill of goods and/or purchase order is NOT an acknowledgment that the products purchased are designed and configured correctly. The purchase agrees and acknowledges that it is the customer's responsibility to adhere strictly to all information contained in the Product Specification Sheets.

There is often more than one way to design, configure and layout an LED lighting application properly to achieve the same lighting effect. Elemental LED strongly recommends that licensed professionals be used in the design and installation of lighting systems that include Elemental LED products. The specifications include important information that a designer and installer should carefully review and strictly follow. Qualified designers and certified and/or licensed installers, with access to the final installation environment, customer goals, and Elemental LED product specifications can make the requisite decisions appropriate for a successful finished lighting application.